

Maniglia Inox 3A

ACCESSORI

Caratteristiche: Maniglia con rondella

Features: Handle with supporting washer

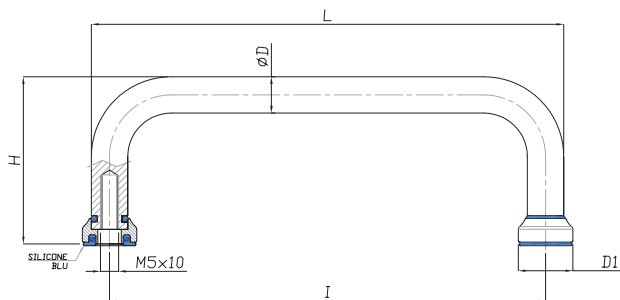

| CODICE - CODE | DESCRIZIONE - description | DIMENSIONI PRINCIPALI - MAIN DIMENSIONS | | | | | |
|---------------|-------------------------------|---|-----|----|----|----|-------|
| | | L | I | D | H | D1 | F |
| 40003L/3A | MANIGLIA INOX CURVA LUCIDA 3A | 98 | 88 | 10 | 46 | 15 | M5x10 |
| 40004L/3A | MANIGLIA INOX CURVA LUCIDA 3A | 110 | 100 | 10 | 46 | 15 | M5x10 |
| 40005L/3A | MANIGLIA INOX CURVA LUCIDA 3A | 130 | 120 | 10 | 46 | 15 | M5x10 |
| 40006L/3A | MANIGLIA INOX CURVA LUCIDA 3A | 190 | 180 | 10 | 46 | 15 | M5x10 |

Materiali:
AISI 304 (su richiesta AISI 316)
Guarnizione a tenuta in silicone Blu

Materials:
AISI 304 (AISI 316 on request)
Gasket blue silicone



Volantino 3A

ACCESSORIES

Star knob

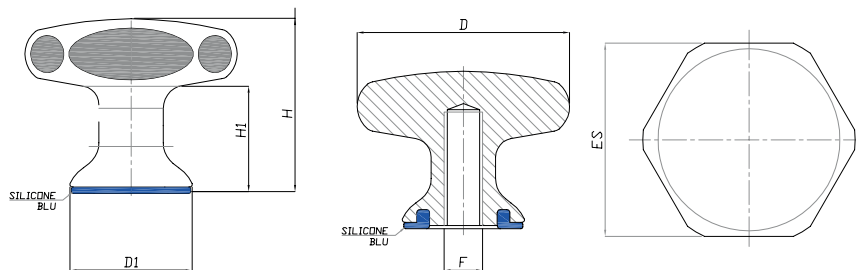

| CODICE - CODE | DESCRIZIONE - description | DIMENSIONI PRINCIPALI - MAIN DIMENSIONS | | | | | |
|------------------|-----------------------------------|---|----|----|--------|----|----|
| | | D | D1 | ES | F | H | H1 |
| 30005/27SL20/3A | VOLANTINO INOX D27 ES.24 M5 "3A" | 27 | 15 | 24 | M5x15 | 20 | 13 |
| 30010E/33SL24/3A | VOLANTINO INOX D33 ES.30 M6 "3A" | 33 | 19 | 30 | M6x20 | 24 | 13 |
| 30020E/40SL28/3A | VOLANTINO INOX D40 ES.36 M8 "3A" | 40 | 25 | 36 | M8x20 | 28 | 16 |
| 30030E/50SL30/3A | VOLANTINO INOX D50 ES.46 M10 "3A" | 50 | 25 | 46 | M10x25 | 30 | 16 |
| 30050E/65SL40/3A | VOLANTINO INOX D65 ES.60 M12 "3A" | 65 | 31 | 60 | M12x25 | 40 | 24 |

Materiali:
AISI 304 (su richiesta AISI 316)
Guarnizione a tenuta in silicone Blu

Materials:
AISI 304 (AISI 316 on request)
Gasket blue silicone



Chiusura Inox 3A & IP69K

Caratteristiche: 1/4 giro da fermo

Features: 1/4 turn latch

ACCESSORI

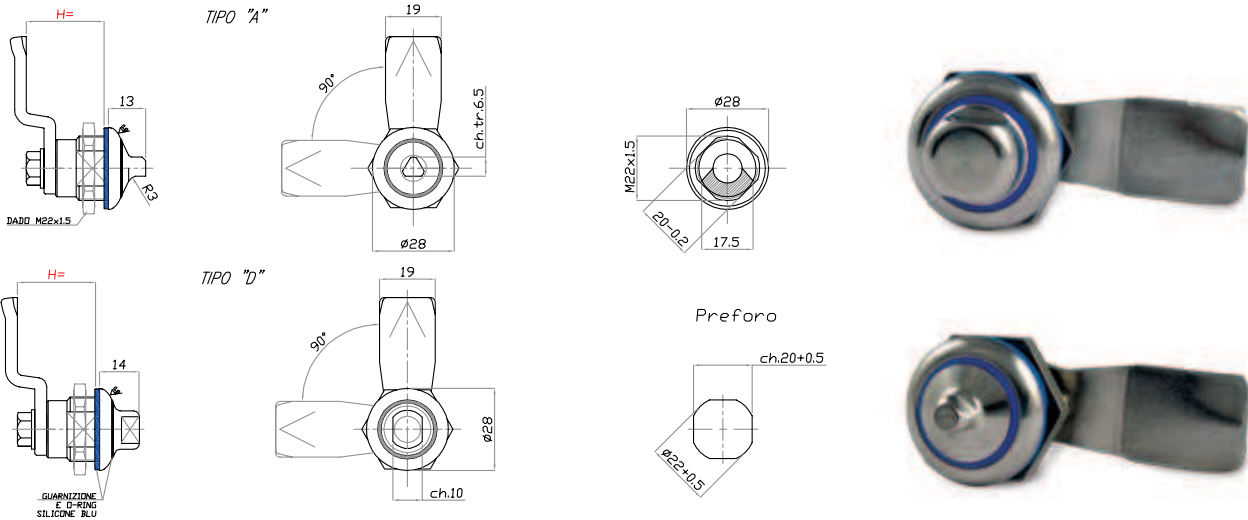

| CODICE - CODE △ | CODICE - CODE ◻ | H | DESCRIZIONE - description |
|--------------------|--------------------|----|--|
| 70170HYG/A/3A | 70170HYG/D/3A | 18 | CHIUSURA 1/4GIRO D28 H18-HYGIENIC-IP69K - "3A" |
| 70171HYG/A/3A | 70171HYG/D/3A | 20 | CHIUSURA 1/4GIRO D28 H20-HYGIENIC-IP69K - "3A" |
| 70172HYG/A/3A | 70172HYG/D/3A | 22 | CHIUSURA 1/4GIRO D28 H22-HYGIENIC-IP69K - "3A" |
| 70173HYG/A/3A | 70173HYG/D/3A | 24 | CHIUSURA 1/4GIRO D28 H24-HYGIENIC-IP69K - "3A" |
| 70174HYG/A/3A | 70174HYG/D/3A | 26 | CHIUSURA 1/4GIRO D28 H26-HYGIENIC-IP69K - "3A" |
| 70175HYG/A/3A | 70175HYG/D/3A | 28 | CHIUSURA 1/4GIRO D28 H28-HYGIENIC-IP69K - "3A" |

• Chiusura inox ¼ di giro certificata IP69K.
Massimo grado di protezione.

Materiali: corpo AISI 304
Perno centrale AISI 304
Vite AISI 304
Dado AISI 304
Aletta AISI 304
O-Ring a tenuta in silicone Blu
Su richiesta AISI 316

• Stainless Steel latch ¼ turn certified IP69K.
Maximum protection grade

Material: body AISI 304
Inside pivot AISI 304
Screws AISI 304
Nut AISI 304
Closing tongue AISI 304
O-Ring blue silicone
On Request AISI 316



ACCESSORI & A

CHIAVE A

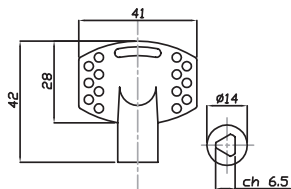

CHIAVE D

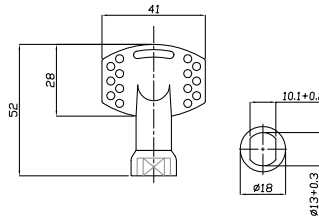

| CODICE CODE | descrizione - description |
|----------------|---|
| 70090/CH-A | CHIAVE TRIANGOLARE 6,50 IN PLASTICA - ANTI SCASSO |
| 70090/CH-D | CHIAVE TIPO "HYGIENIC" CON INSERTO IN METALLO - ANTI SCASSO |

A richiesta si eseguono sede chiavi differenti.
Different keys can be manufactured on request.

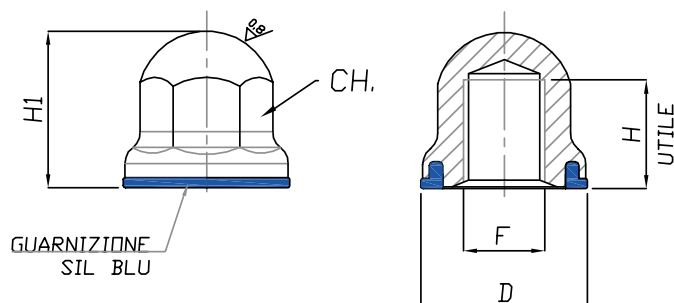

| CODICE | DESCRIZIONE | DIMENSIONI PRICIPALI | | | | |
|------------------|---|----------------------|--------------|------------|-----------|-----------|
| | | D | CH. | F | H | H1 |
| DDM3I/3A | DADO INOX D15 ES.10 M3 GUARN. SIL BLU | 15 | ES.10 | M3 | 8 | 12 |
| DDM4I/3A | DADO INOX D15 ES.10 M4 GUARN. SIL BLU | 15 | ES.10 | M4 | 8 | 12 |
| DDM5I/3A | DADO INOX D19 ES.14 M5 GUARN. SIL BLU | 19 | ES.14 | M5 | 12 | 17 |
| DDM6I/3A | DADO INOX D19 ES.14 M6 GUARN. SIL BLU | 19 | ES.14 | M6 | 12 | 17 |
| DDM8I/3A | DADO INOX D25 ES.17 M8 GUARN. SIL BLU | 25 | ES.17 | M8 | 15 | 23 |
| DDM10I/3A | DADO INOX D25 ES.17 M10 GUARN. SIL BLU | 25 | ES.17 | M10 | 15 | 23 |
| DDM12I/3A | DADO INOX D25 ES.17 M12 GUARN. SIL BLU | 25 | ES.17 | M12 | 15 | 23 |
| DDM14I/3A | DADO INOX D31 ES.22 M14 GUARN. SIL BLU | 31 | ES.22 | M14 | 20 | 28 |
| DDM16I/3A | DADO INOX D31 ES.22 M16 GUARN. SIL BLU | 31 | ES.22 | M16 | 20 | 28 |
| DDM20I/3A | DADO INOX D36 ES.27 M20 GUARN. SIL BLU | 36 | ES.27 | M20 | 25 | 34 |
| DDM24I/3A | DADO INOX D43 ES.32 M24 GUARN. SIL BLU | 43 | ES.32 | M24 | 30 | 40 |

Su Richiesta:

Passo Fine
Filetto Unc & Fnc
Filetto Maschio
Guarnizione NBR Nero
Aisi 316

On Request:

Fine Pitch
Unc & Fnc Thread
Male Thread
Black Nbr Gasket
Aisi 316

Guarnizioni esterne 3-A in silicone blu

ACCESSORI



Caratteristiche: GUARNIZIONI IN SILICONE ALIMENTARE BLUE CERTIFICATO

Features: GASKETS IN BLUE SILICONE CERTIFIED FOR FOOD INDUSTRY

| CODICE | DESCRIZIONE |
|--------|-------------|
|--------|-------------|



| | |
|-------------------------------|---|
| GE157/3A 100pcs box | GUARNIZIONE ESTERNA D14,5x7,5 SILICONE BLU EXTERNAL GASKET D14,5x7,5 BLUE SILICONE |
|-------------------------------|---|

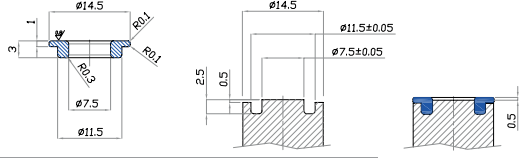

| | |
|--------------------------------|---|
| GE1910/3A 100pcs box | GUARNIZIONE ESTERNA D18,5x10,5 SILICONE BLU EXTERNAL GASKET D18,5x10,5 BLUE SILICONE |
|--------------------------------|---|

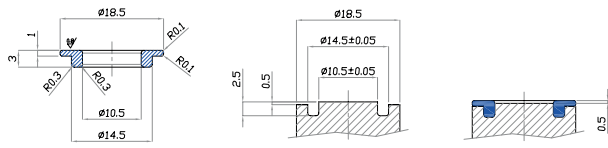

"Produzione possibile anche in EPDM e NBR, con colori a scelta. Richiesto un lotto minimo di produzione"

"Possibility to produce these gaskets in EPDM & NBR, with different colours. MOQ required"

| | |
|--------------------------------|---|
| GE2418/3A 100pcs box | GUARNIZIONE ESTERNA D24x18 SILICONE BLU EXTERNAL GASKET D24x18 BLUE SILICONE |
|--------------------------------|---|

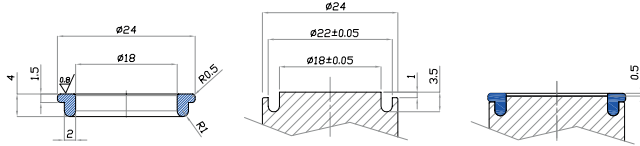

| | |
|--------------------------------|---|
| GE3023/3A 100pcs box | GUARNIZIONE ESTERNA D30x23 SILICONE BLU EXTERNAL GASKET D30x23 BLUE SILICONE |
|--------------------------------|---|

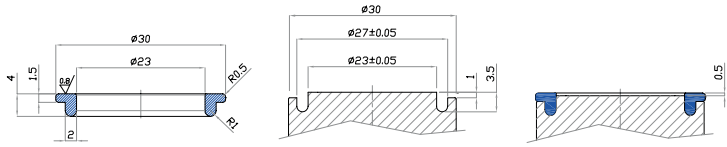

| | |
|--------------------------------|---|
| GE3527/3A 100pcs box | GUARNIZIONE ESTERNA D35x27 SILICONE BLU EXTERNAL GASKET D35x27 BLUE SILICONE |
|--------------------------------|---|

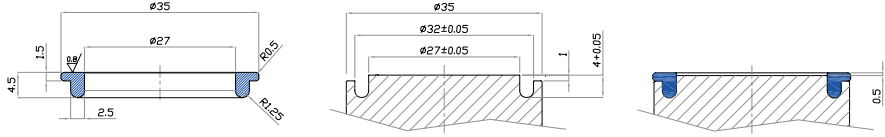

| | |
|--------------------------------|---|
| GE4233/3A 100pcs box | GUARNIZIONE ESTERNA D42x33,5 SILICONE BLU EXTERNAL GASKET D42x33,5 BLUE SILICONE |
|--------------------------------|---|

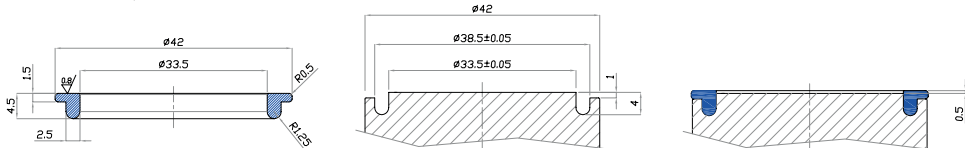

| | |
|--------------------------------|---|
| GE5040/3A 100pcs box | GUARNIZIONE ESTERNA D50x40,5 SILICONE BLU EXTERNAL GASKET D50x40,5 BLUE SILICONE |
|--------------------------------|---|

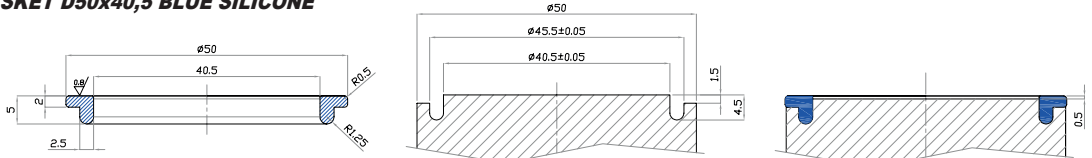

ACCESSORI & A

| CODICE | DESCRIZIONE |
|--------|-------------|
|--------|-------------|

GI2216/3A
100pcs box

GUARNIZIONE INTERNA D22x16 SILICONE BLU
INTERNAL GASKET D22x16 BLUE SILICONE

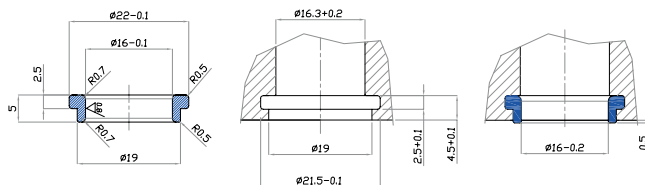

GI2620/3A
100pcs box

GUARNIZIONE INTERNA D26x20 SILICONE BLU
INTERNAL GASKET D26x20 BLUE SILICONE

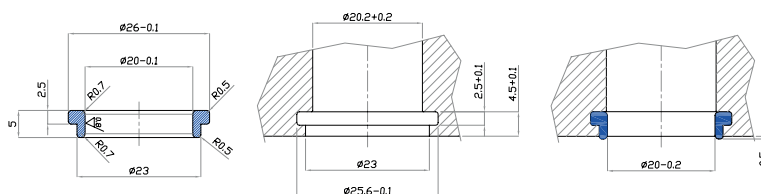

"Produzione possibile anche in EPDM e NBR, con colori a scelta. Richiesto un lotto minimo di produzione"

"Possibility to produce these gaskets in EPDM & NBR, with different colours. MOQ required"

GI3024/3A
100pcs box

GUARNIZIONE INTERNA D30x24 SILICONE BLU
INTERNAL GASKET D30x24 BLUE SILICONE

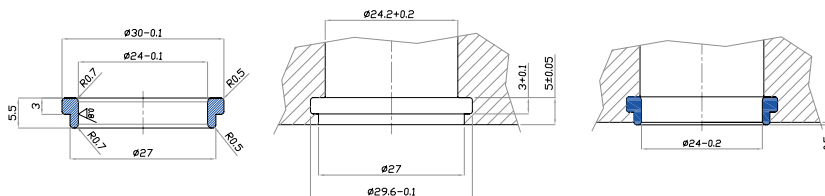

GI3630/3A
100pcs box

GUARNIZIONE INTERNA D36x30 SILICONE BLU
INTERNAL GASKET D36x30 BLUE SILICONE

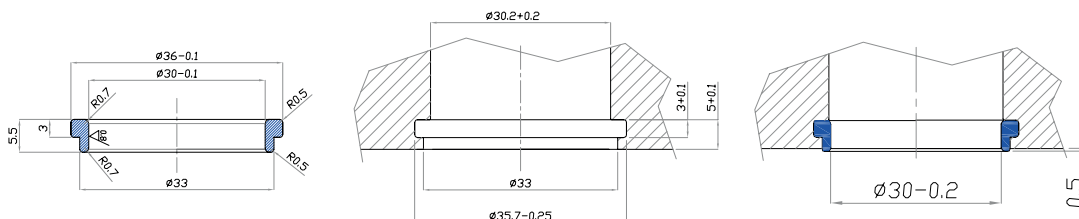

GI4236/3A
100pcs box

GUARNIZIONE INTERNA D42x36 SILICONE BLU
INTERNAL GASKET D42x36 BLUE SILICONE

